



Traffic. Transportation Planning. Parking. Design.

400 S. Houston Street, Suite 330
Dallas, TX 75202
214.748.6740 + Fax: 214.748.7037
deshazogroup.com

MEMORANDUM

To: Mr. John Bunten, Mr. Stanley Thomas — YMCA of Metropolitan Dallas
CC: Mr. Duncan Fulton, and Mr. Larry Good — Good, Fulton & Farrell Architects
From: Steve E. Stoner, P.E., PTOE — DeShazo Group, Inc.
Date: May 1, 2012
Re: Park Cities YMCA – Supplement to Traffic Impact Analysis
DeShazo Project No. 10139

Background

Pursuant to the request by the City of University Park, **DeShazo Group, Inc.** has completed an analysis of five additional intersections in the vicinity of the Park Cities YMCA. This memorandum will serve as a supplement to the original Traffic Impact Analysis issued on March 15, 2012.

The additional intersections include:

- a. Douglas & Shenandoah
- b. Douglas & Normandy
- c. Douglas & San Carlos
- d. Preston & Mockingbird
- e. Preston & University
- f. Preston & San Carlos

A map of the expanded study area is provided in Exhibit 1.

The morning and afternoon peak period traffic counts were collected at the additional intersections on April 11, 2012, and are summarized in Exhibit 2--detailed data provided in the Appendix. (The original study area traffic data is also provided in Exhibit 2.)

NOTE: The intersection of Preston Road and San Carlos was added after the data collection was completed. However, the volumes were extrapolated based upon traffic volume data from adjacent intersections.

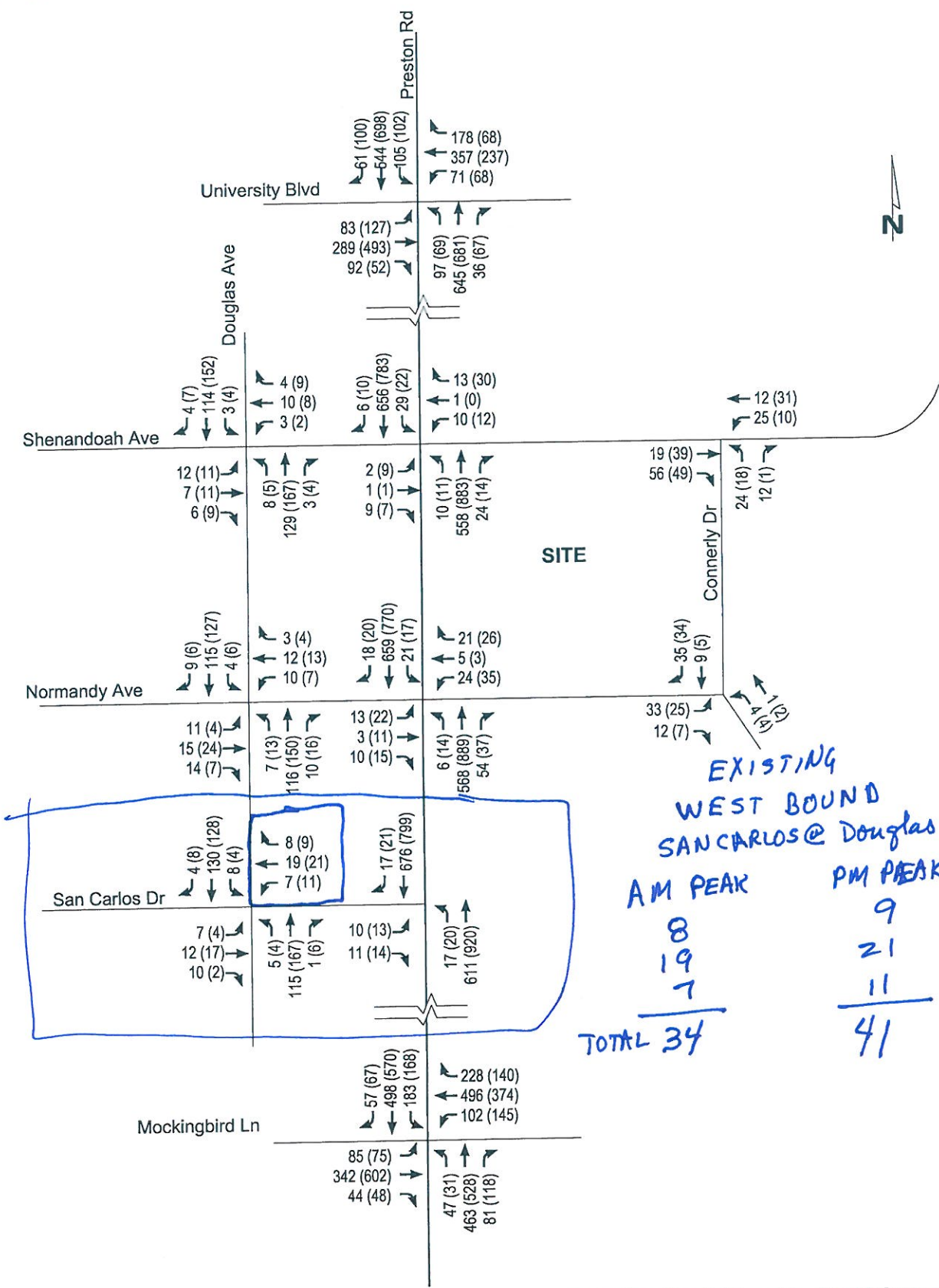

LEGEND: ← xxx(yyy)
 xxx - AM Peak Hour Volumes
 yyy - PM Peak Hour Volumes

Existing Peak Hour Traffic Volumes

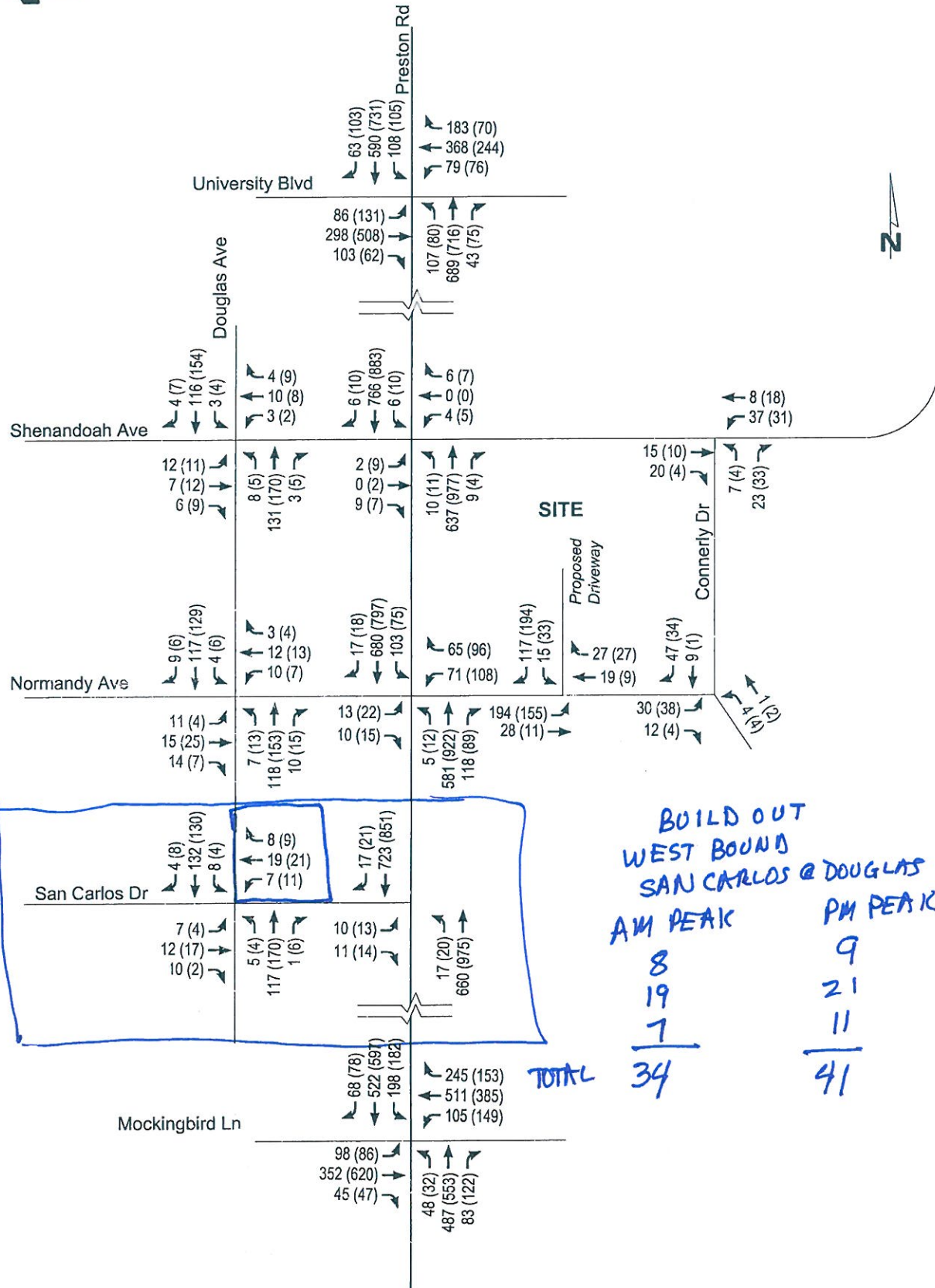

LEGEND: ← xxx(yyy)
 xxx - AM Peak Hour Volumes
 yyy - PM Peak Hour Volumes

Buildout Peak Hour Traffic Volumes